

EMBRACE THE OUTDOORS

MDT-TEX BRAND

---

MDT - THE COMPANY

**MDT**-tex<sup>®</sup>

Membranes & Structures

---

# ABOUT MDT

MDT-TEX BRAND

---

## IN SHORT:

**MDT DESIGNS, MANUFACTURES AND SUPPLIES  
INNOVATIVE, HIGH-QUALITY SUN PROTECTION  
SYSTEMS, MEMBRANE CONSTRUCTIONS, AND  
CUSTOM-MADE PRODUCTS FOR TEXTILE  
OUTDOOR ARCHITECTURE TO CUSTOMERS ALL  
OVER THE WORLD**

THE COMPANY CARRIES OUT THE ENTIRE  
PRODUCTION PROCESS IN ITS OWN MODERNIZED  
FACTORIES AT INTERNATIONAL LOCATIONS.  
THIS GUARANTEES HIGHEST QUALITY FOR  
INNOVATIVE PRODUCTS AND ENSURES ABSOLUTE  
SUPPLY SECURITY

# OUR LOCATIONS

MDT-TEX BRAND

---

---

Germany,  
Switzerland, Latvia,  
USA, Australia

---

## 1 GERMANY

HARDHEIM

- Headquarter
- Aluminum, steel and textile
- Storage
- General and Static engineering
- National and International Sales
- Key Account Management
- Research & Development

## 2 SWITZERLAND

TÄGERWILEN

- Design and Development
- 3D individuell textile formfinding software
- Architecture and innovations
- International Sales
- Key Account Management

## 3 LATVIA

RIGA

- Aluminum, textile production
- Product design
- Prototyping / 3d printing
- Powder coating

## 4 USA

TYRONE, GA

- International Sales
- Key Account Management
- Supply chain mangagement
- Storage

## 5 AUSTRALIA

FREMANTLE

- International Sales
- Key Account Management
- Storage



# Expertise in PRODUCTION

FROM  
MANUFACTURE  
TO  
SYSTEM  
PROVIDER

MDT-TEX BRAND

## CONSTRUCTION & ENGINEERING

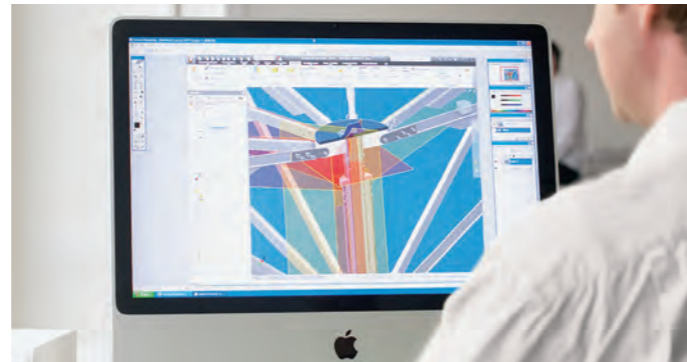

Autodesk Inventor



3D printer



Rapid Prototyping / 3D printer

## METALWORKS



CNC Metalworking



Aluminum welding robot



Extrusions

## CUTTING AND PREFABRICATING



Textile layer machines



Automated sewing machine



CNC textile cutter

**ALL PRODUCTION STEPS  
ARE CARRIED OUT IN OUR  
IN-HOUSE FACILITY,**

FOR OPTIMUM QUALITY,  
INDEPENDENCE  
AND AVAILABILITY.

# Expertise in PRODUCTION

FROM  
MANUFACTURE  
TO  
SYSTEM  
PROVIDER

MDT-TEX BRAND

## SEWING AND WELDING



Sewing center



Special sewing machine



Ultrasonic textile welder

## TEXTILE PRODUCTION, WEAVING



PTFE loom

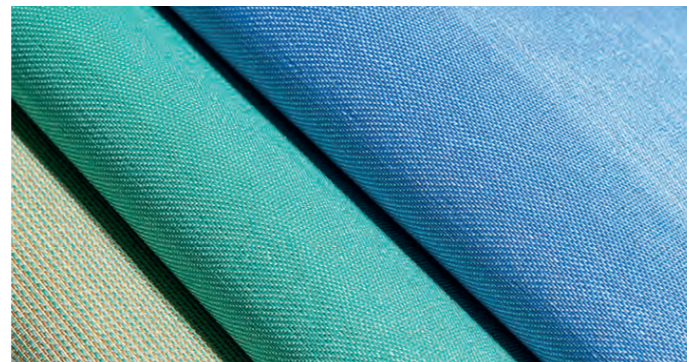

Coloured PTFE fabric



Textile diversity

## PRINTING AND COATING



Digital printing machine



Water resistant coating

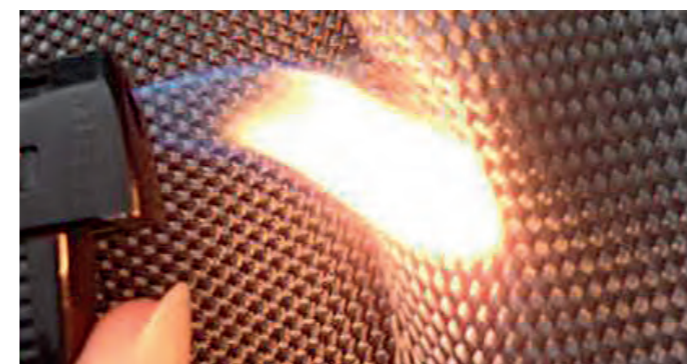

Flame-retardant coating

## LOGISTICS AND ASSEMBLING



2x25 to overhead cranes



Final assembly with 30m span Wire



Wireless Warehouse-Concept

# Expertise in COMPLETION

MDT-TEX BRAND

**THE STEPS  
TO YOUR  
SUCCESS**

THE MDT-TEX  
DESIGN DEVELOPMENT

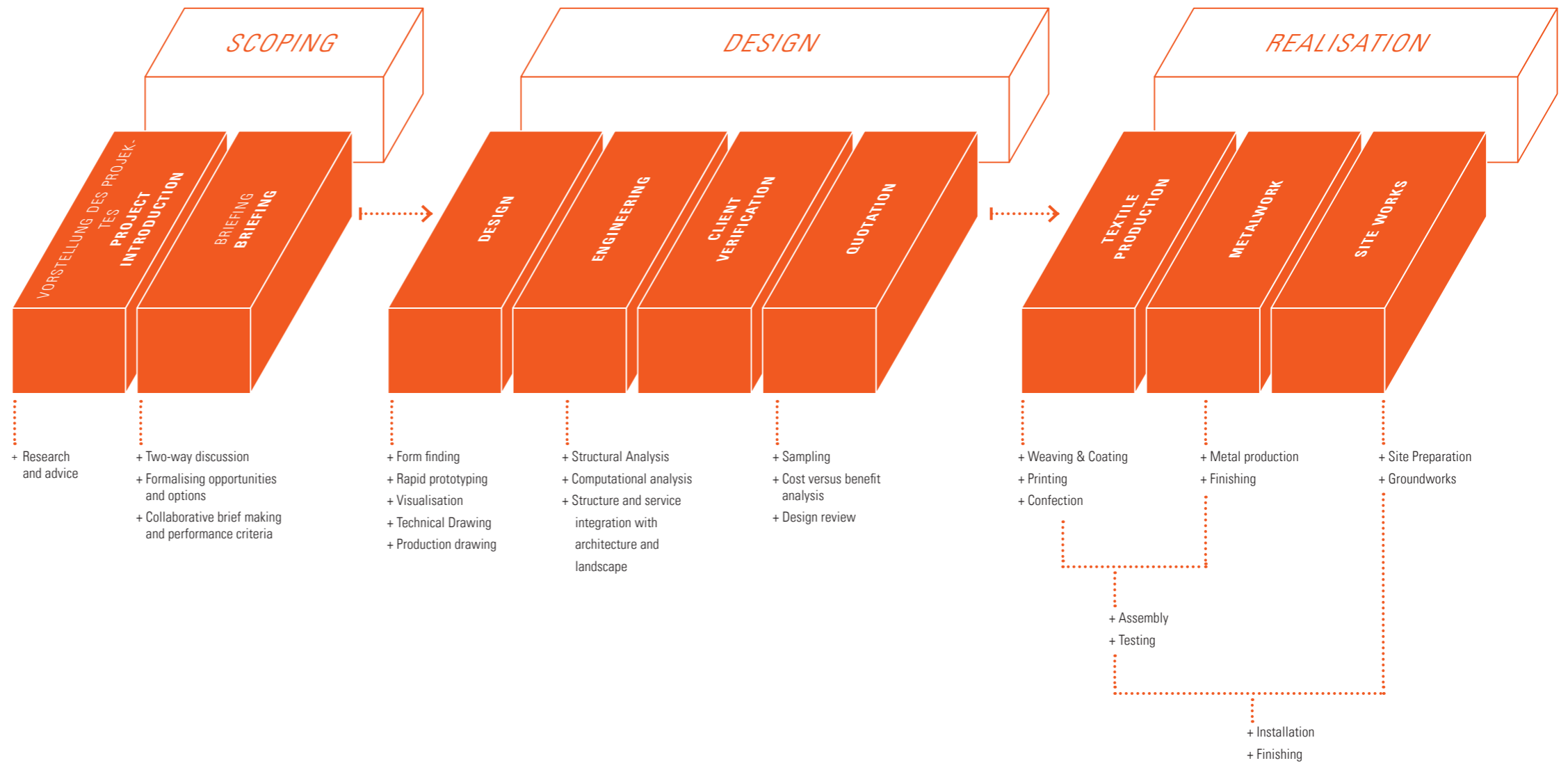

# Business SEGMENTS

MDT-TEX BRAND

**RESTAURANTS**  
**OUTDOOR GASTRONOMY**  
**URBAN DESIGN SOLUTIONS**  
**PUBLIC PLACES**  
**ARCHITECTURAL PROJECTS**  
**TEMPORARY EVENTS**



Restaurant Refettorio Munich

## RESTAURANTS

MDT-tex umbrellas create an atmospheric outdoor environment for Bars, Restaurants and Hotels and suit ambitious and individual design solutions.



Maincafe, Frankfurt a. Main

## OUTDOOR GASTRONOMY

For gastronomic licensees we can offer attractive solutions for the extension of their outdoor space and revenue-driven hospitality areas.



Village square Pill, Austria

## URBAN DESIGN SOLUTIONS

Community and urban solution may have a great impact on marketing oriented events as well as on social interaction for public.



Market Car Place, Youghal, Ireland

## PUBLIC PLACES

The extension of usable space to the outdoors creates new possibilities of interaction, independent of the weather – people meeting people.



Meeting House Square, Dublin, Ireland

## ARCHITECTURAL PROJECTS

As we plan and deliver ready-for-use textile outdoor architecture we serve as an efficient and competent partner for architects, which enables them to focus on their core business.



Furniture fair Milan

## TEMPORARY EVENTS

High-quality tulip and double-membrane umbrellas are available for temporary events exclusively at MDT-tex. They serve as a highlight for a series of events, such as the Expo Milano.

# Business COLLABORATION

MDT-TEX BRAND

---

**MDT-TEX HAS BECOME  
THE IDEAL PARTNER FOR THE  
CONVERSION FROM INDIVIDUAL,  
TAILOR-MADE AND  
VISIONARIES ARCHITECTURE  
AND SCENERY PROJECTS**

INTERNATIONAL ARCHITECT'S  
OFFICES LIKE  
**GRIMSHAW (UK),  
UNSTUDIO (NL),  
MAX DUDLER (CH, D) OR  
ATELIER OI (CH)**  
PROVE THE SUCCESSFUL  
COOPERATION THROUGH THE  
TOGETHER REALIZED PROJECTS.

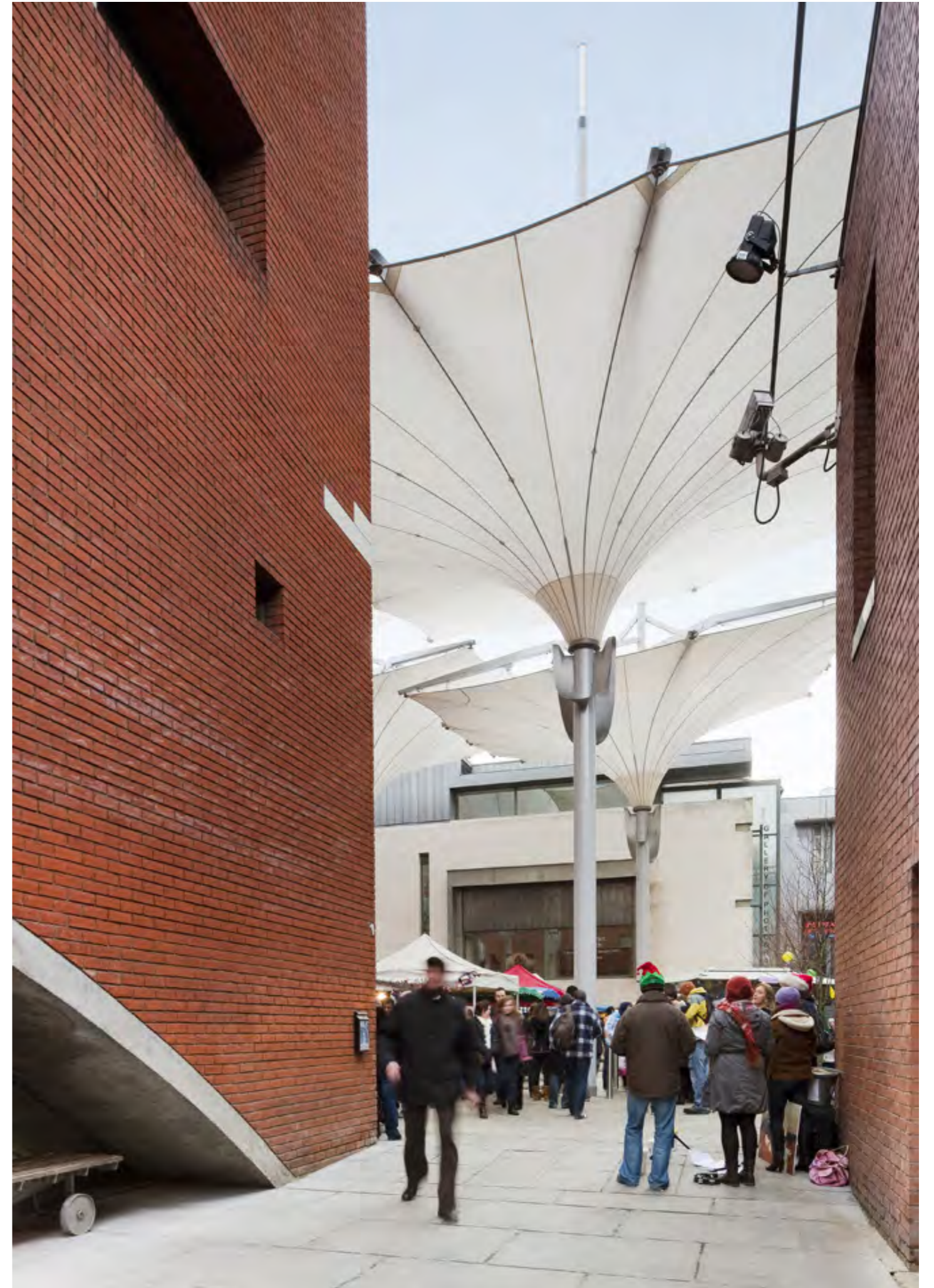



# MDT PRODUCTS

FROM  
**STANDARD**  
TO  
**LARGE SCALE  
& CUSTOM**  
PRODUCTS

MDT-TEX BRAND



**TYPE EV**  
TENSION

This new, strong and extra-lightweight canopy system covers an indefinite amount of space with flexible configurations. Available in three shapes and equipped with a modular flooring, it is extremely fast to erect.



**TYPE TS, TH, THK & E**  
USE OF ENERGY

Both Type E and T umbrellas may be equipped with solar cells, which make mobile charging of smart-phones and other functions possible. Further developments include water storage and cooling systems.



**TYPE H**  
WOODEN UMBRELLA

Wooden umbrellas are still considered as being one of the most elegant umbrellas with a nostalgic flair. Every single piece is handcrafted from high-quality, sustainable eucalyptus wood.



**TYPE S7/16, EH, AVH & SAH**  
M-HOME

The home collection is the one to be used for private clients. Basically the sizes of the standard umbrellas have been reduced.



**TYPE G, S & T**  
ALUMINIUM UMBRELLAS

Our telescopic umbrellas, which are available in either square, rectangular or round configurations, offer safe sun and rain protection for both single events and permanent installations.



**TYPE E**  
TULIP UMBRELLAS

By their elegant and textile design tulip umbrellas transform each occasion into a special one. Extendable by free choice of color, lighting and even scent.



**TYPE SA**  
SIDEARM UMBRELLAS

This model perfectly suits the needs of modern exteriors. Due to its space-saving design, open space is created by subtracting the mast from the covered area. Ideal for terraces and balconies for example.



**TYPE AV**  
DOUBLE MEMBRANE UMBRELLAS

Double-membrane umbrellas combine high-tech with stylistic elements. Internal lighting and clad bonded system allows the customer to connect multiple umbrellas to form a closed roof.

# MDT PRODUCTS

FROM  
**STANDARD**  
TO  
**LARGE SCALE  
& CUSTOM**  
PRODUCTS

MDT-TEX BRAND



**TYPE SHT**  
SHADE STRUCTURES- TULIP

A permanent sun protection, which places the emphasis on an extraordinary design. Perfectly suitable for permanent use due to high wind stability.



**TYPE SHP**  
SHADE STRUCTURES- PAGODE

The pagoda configuration is something special. It is wind stable and recommended to be used permanently. This model is also available as a double-skinned shade structure.



**TYPE SP**  
DOUBLE MEMBRANE CONSTRUCTION

This model has a surrounding rain gutter as well as an integrated drain. It is perfectly suitable as a permanent installation.



**TYPE ET**  
DESIGN UMBRELLAS

This elliptical 'goblet' shade structure is tensioned by cables. It is designed for permanent use and additionally has an opening for cleaning of the drainage.



**TYPE GC**  
UMBRELLA BAR

Known as Apres-Ski-Bars in many winter-sport areas, these bars suit catering for many patrons. Also the gastro concept is suitable within smaller dimensions.



**TYPE SE**  
SAIL CONSTRUCTIONS

Two standard configurations include: a 4-point sail and an arch. Both can be used for indoor and outdoor events such as tradeshow, exhibitions and concerts.



**TYPE TENT**  
TENT

The tent is designed for large events, access from all sides. The base has a modular structure and serves as sub-construction.



**TYPE SEA**  
RETRACTABLE SAILS

This sail is suitable for roofing of terraces, playgrounds and public places, cafes, as access from either side is open.

MDT-TEX BRAND

---

# PRODUCTS

**STANDARD PRODUCTS**  
UP TO **6 M**



**TYPE S16**  
Home range  
2,5 m up to 4 m



reddot award 2018  
best of the best







**TYPE E**  
Tulip





**TYPE SA**  
Side Arm

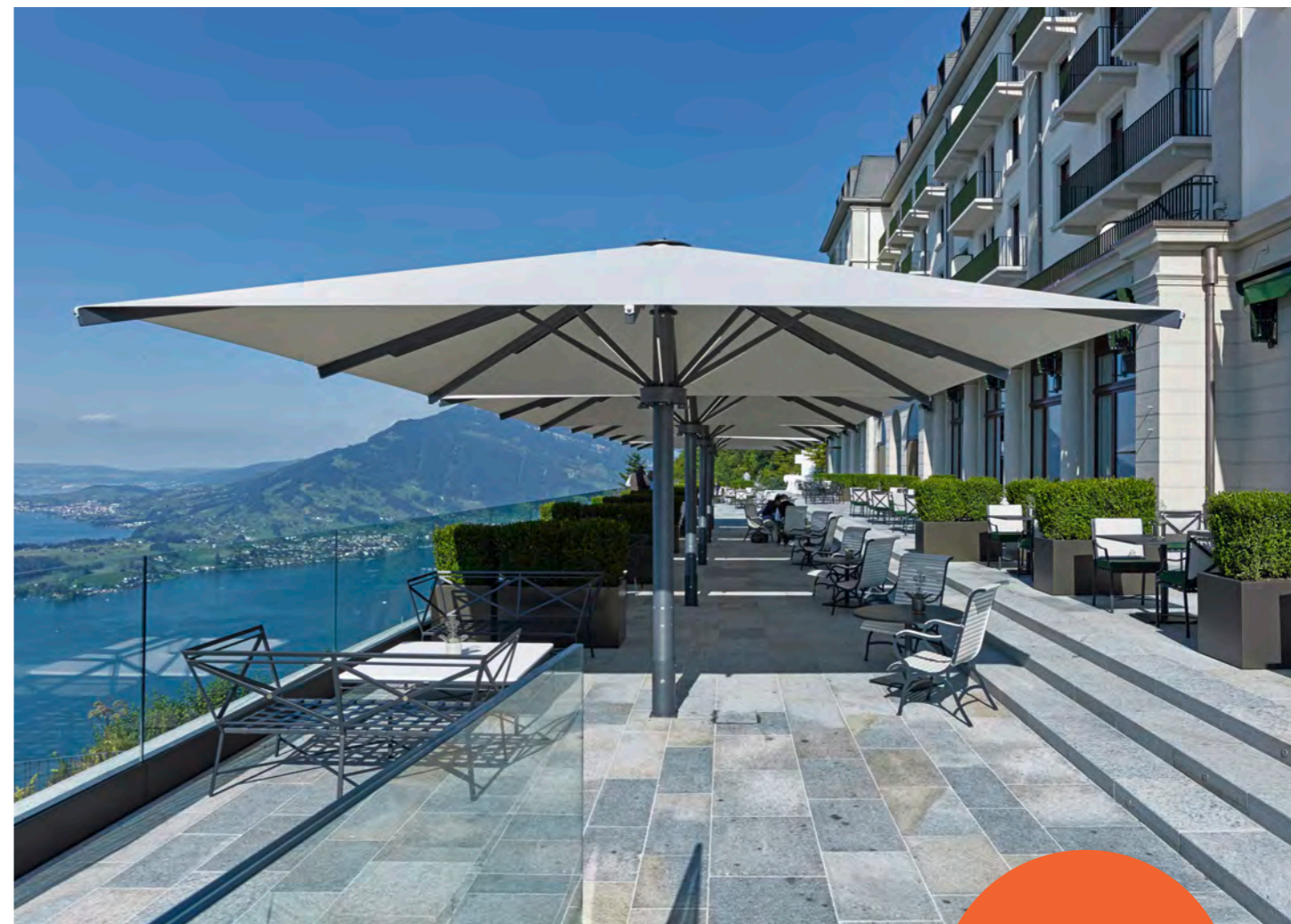

**TYPE T**





**TYPE S**



**TYPE H**  
Wooden

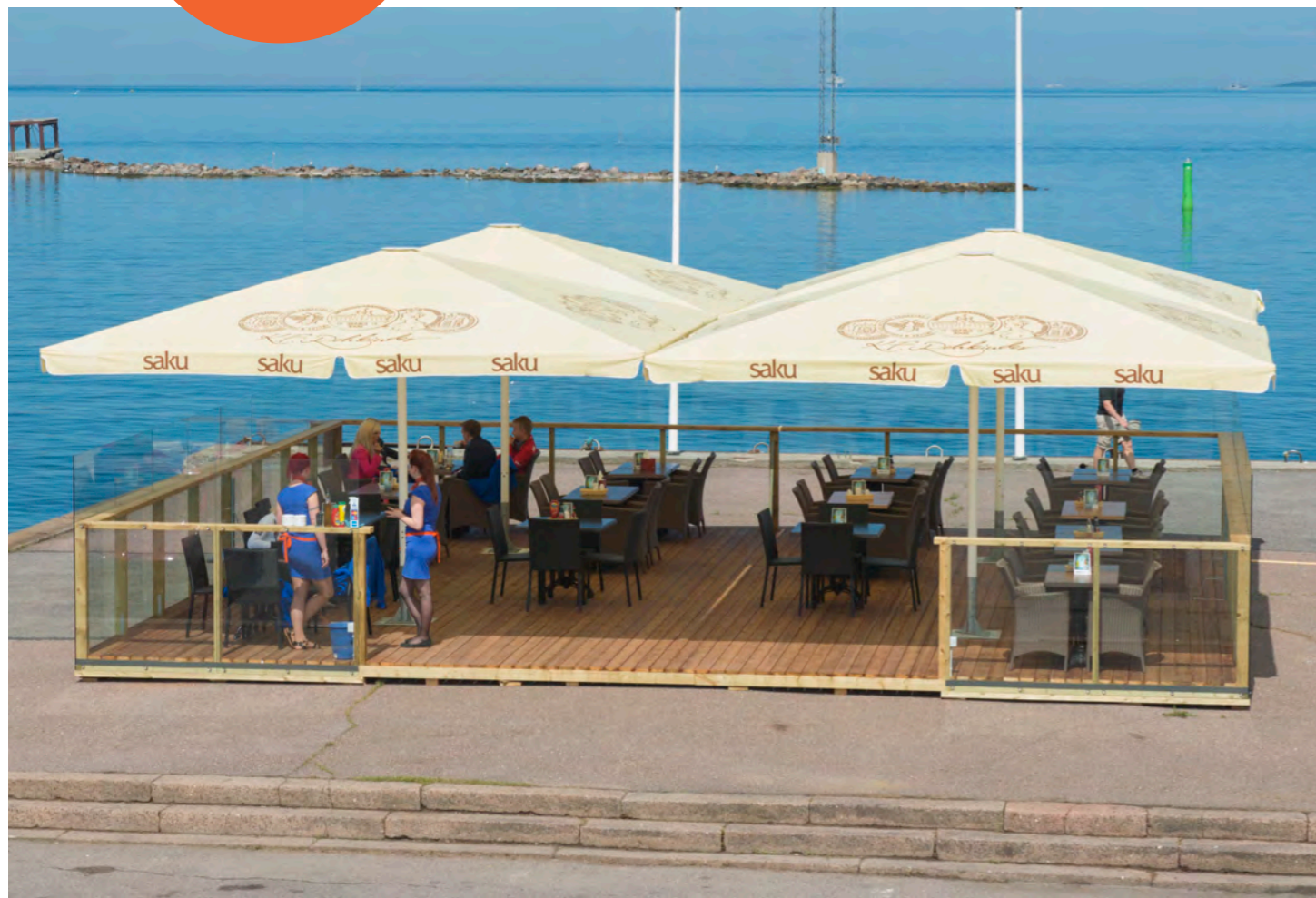





MDT-TEX BRAND

---

# TEXTILE ARCHITECTURE

LARGE SCALE  
AND  
CUSTOM PROJECTS

**TYPE EB**  
Cirrus  
System

AMSTERDAM LIGHT FESTIVAL

**EYE BEACON 2016**

— THE NETHERLANDS



**TYPE PA**  
Cirrus  
System

TECHTEXTIL LIVING IN SPACE

**PROTOTYPE II 2017**

— FRANKFURT AM MAIN



**TYPE E**  
XXL Tulip  
5 x 6 m

**KING ABDULAZIZ  
CENTER 2016**  
— SAUDI ARABIA



**TYPE E**  
XXL Tulip  
ø 10 m

**KING ABDULAZIZ  
CENTER 2016**

— SAUDI ARABIA



**TYPE E**  
XXL Tulip  
11 x 14 m

**MEETING HOUSE  
SQUARE 2012**  
DUBLIN



**TYPE EI**  
5.1 - 5.7 m

**LE SHOP**  
**STUDEN 2012**  
SWITZERLAND



MDT-TEX BRAND

---

# SUSTAINABILITY

**SOLAR ENERGY AND  
WATER HARVESTING**



**TYPE SCP**  
Solar Carport  
5.3 x 5.3 m

# Symmetric SOLAR CARPORT

**FIXED**  
Structure



## TULIP-SHAPED SHADE STRUCTURE

In a new development the tulip-shaped shade structures are transformed into solar ports capable of harvesting solar-energy and rainwater.

The 5.3 x 5.3 m square structure having central mast can serve as shelter for two cars. Given its modular design, several structures can be placed next to each other in a linear or group configuration.

## DIMENSIONS

<b>STRUCTURE</b>	Fixed, steel construction with asymmetric mast and photovoltaic modules above the membrane
<b>MEMBRANE</b>	PVC 650 g/sq.m
<b>FOUNDATION</b>	1.8 x 1.8 x 1.8 m Reinforced concrete

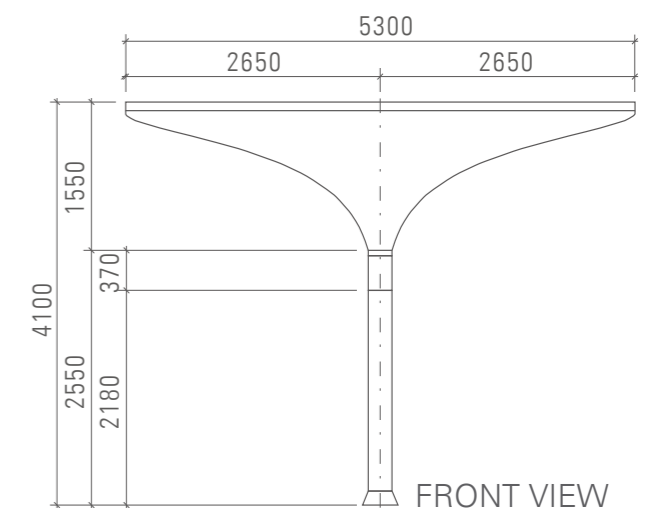

**DIMENSIONS ARE IN MILLIMETERS**  
\*all measurements are rounded

# Asymmetric SOLAR CARPORT

**FIXED**  
Structure



## DIMENSIONS

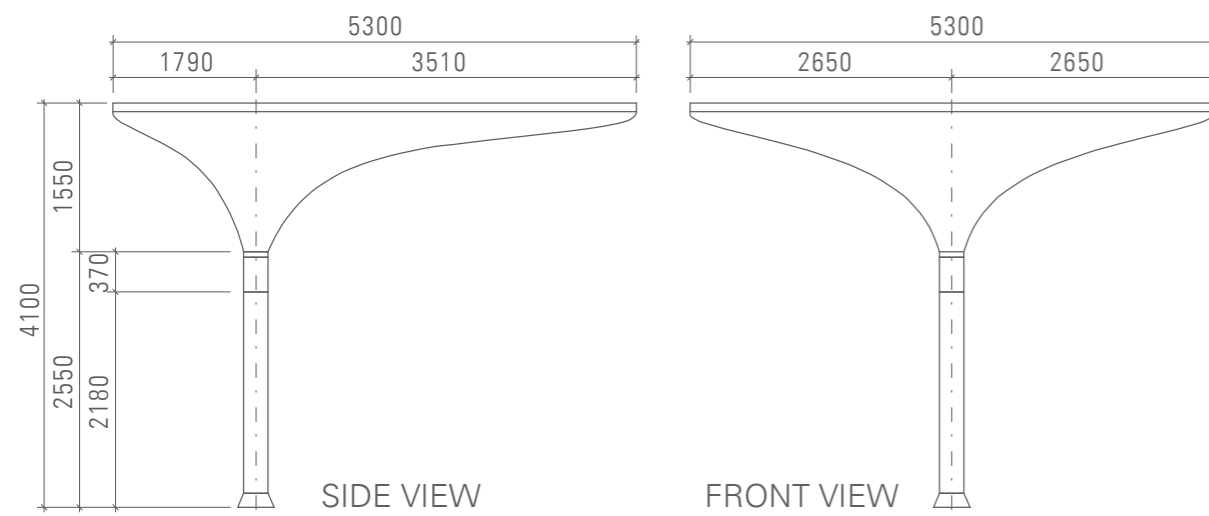

DIMENSIONS ARE IN MILLIMETERS  
\*all measurements are rounded

<b>STRUCTURE</b>	Fixed, steel construction with asymmetric mast and photovoltaic modules above the membrane
<b>MEMBRANE</b>	PVC 650 g/sq.m
<b>FOUNDATION</b>	Reinforced concrete, 1.8 x 1.8 x 1.8 m

# Water HARVESTING

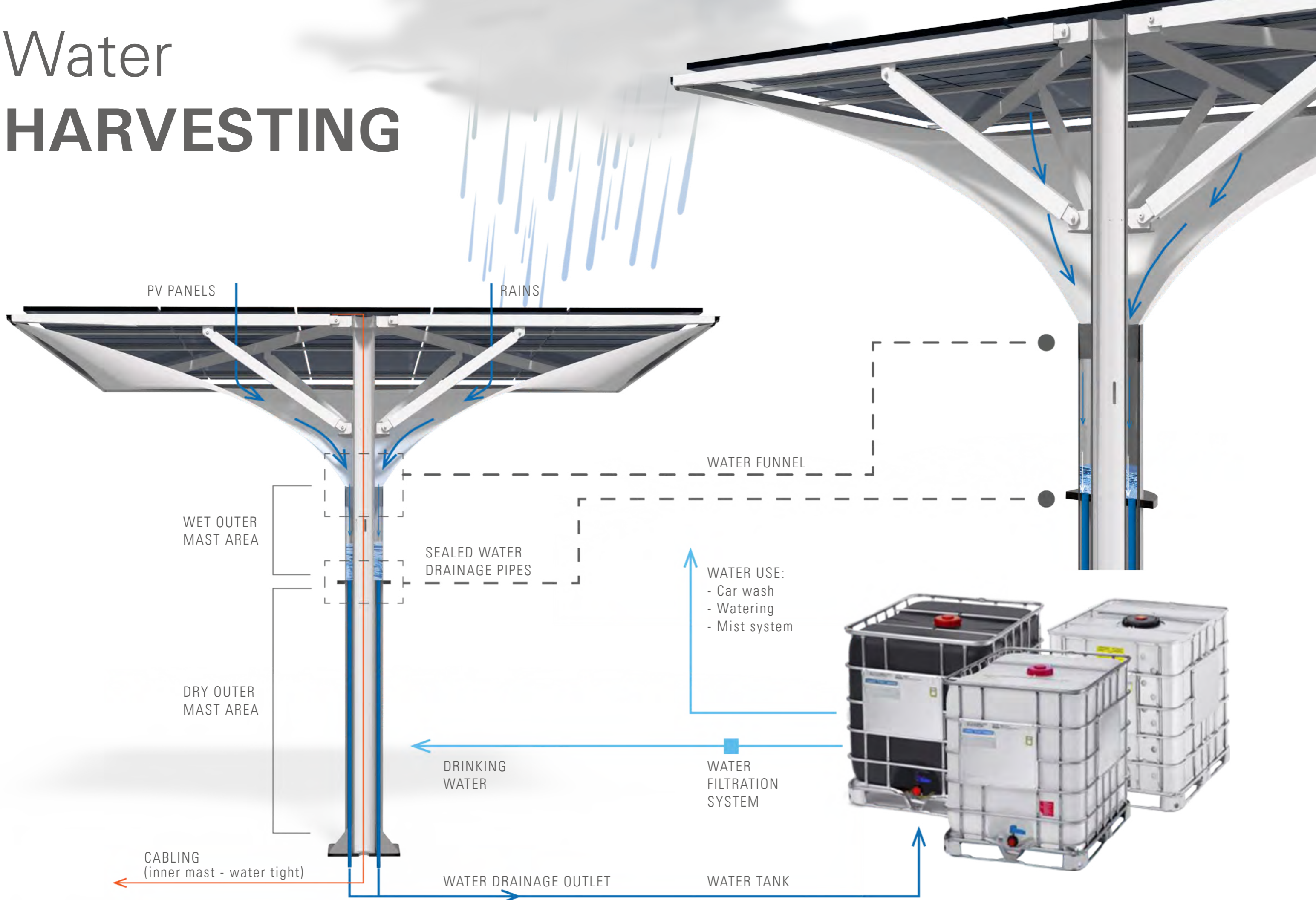



**TYPE E**  
Solar Umbrella  
3 m and 4 m

# SOLAR UMBRELLA

**FOLDABLE**  
Structure



# SOLAR UMBRELLA

**FOLDABLE**  
Structure

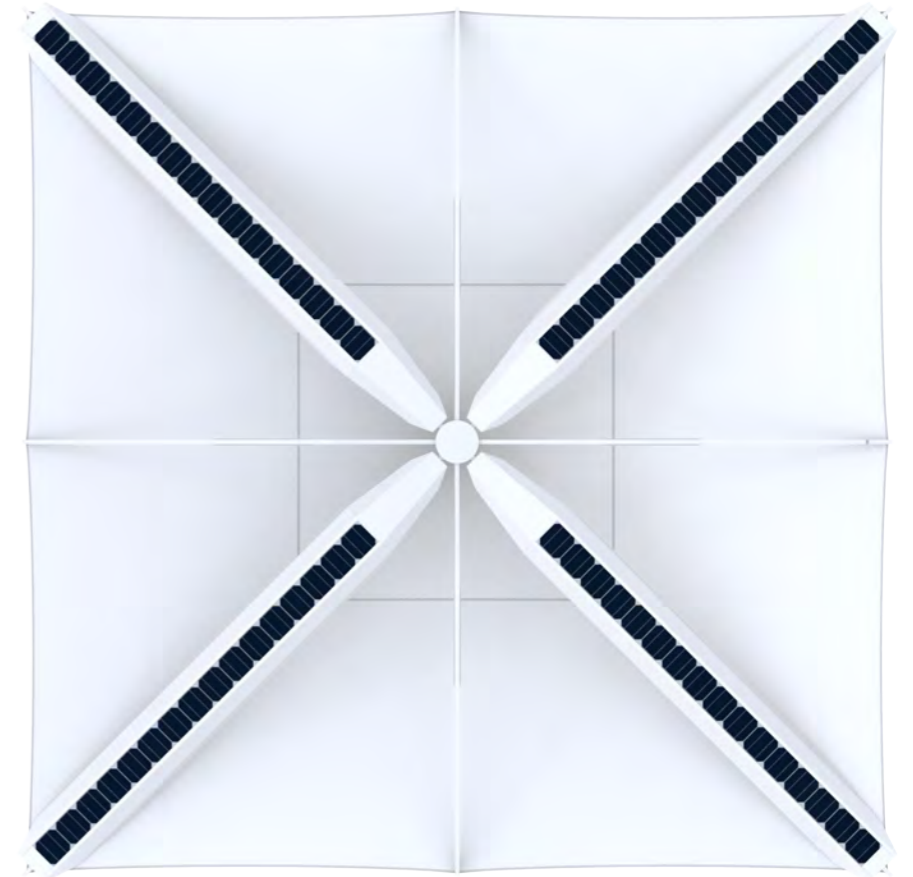
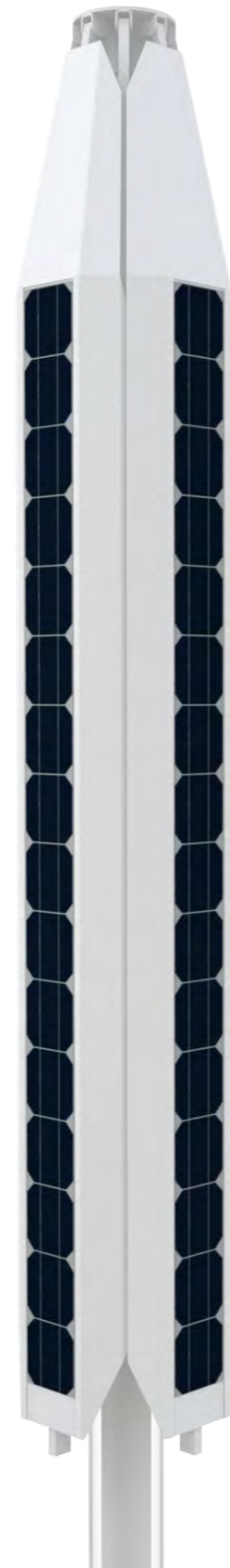



For more information see  
**[www.mdt-tex.com](http://www.mdt-tex.com)**